

Close Coupled Centrifugal Pumps with flanged connections 直結離心式泵浦 法蘭口

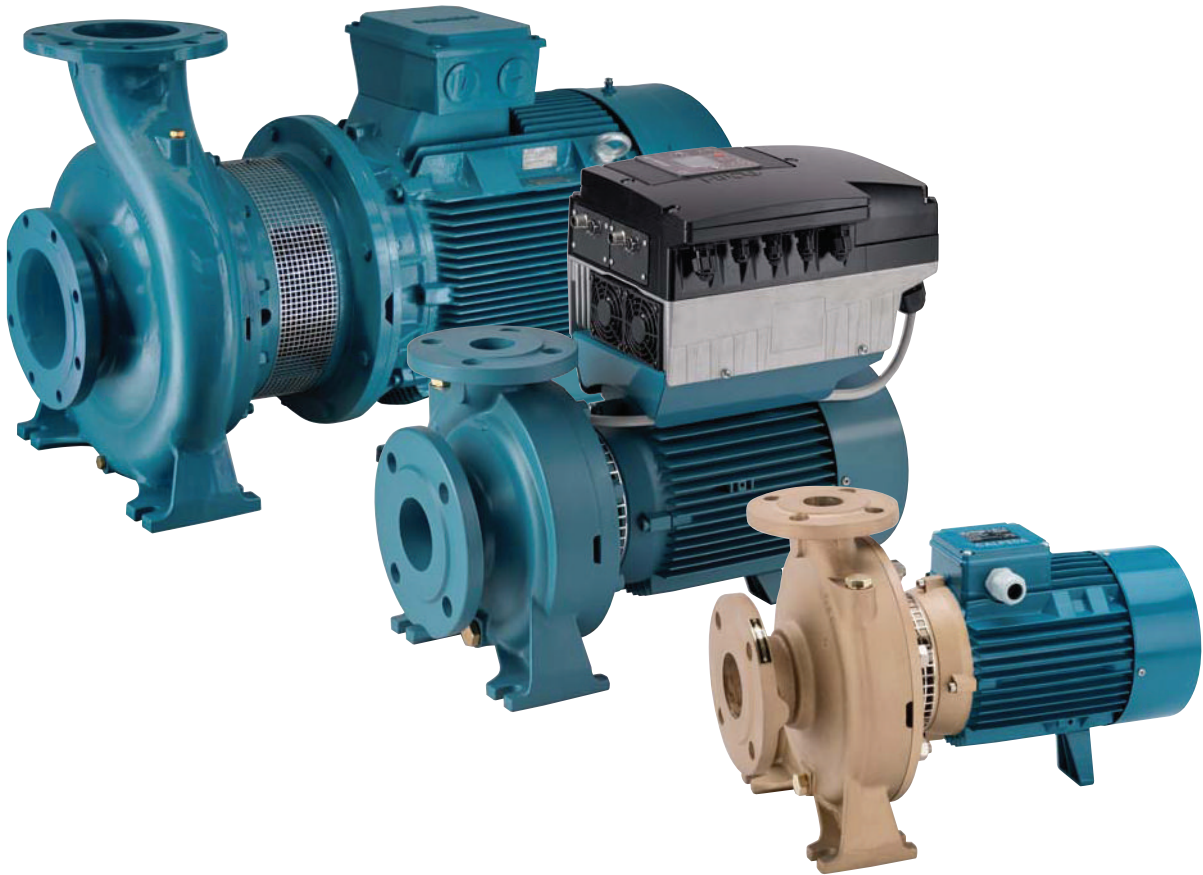

Coverage chart - 性能總表

n ≈ 3450 rpm

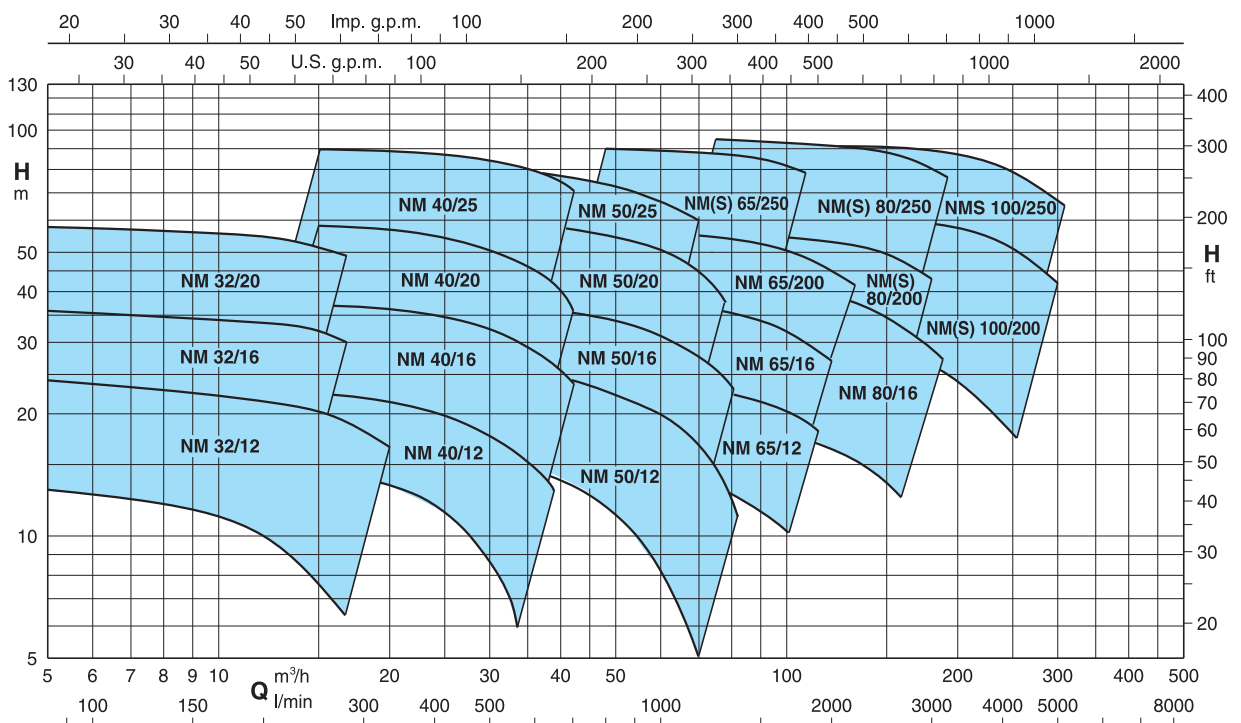

Construction

Close-coupled centrifugal pumps; electric motor with extended shaft directly connected to the pump up to 22 kW, new bracket construction for standard motors (stub-shaft construction) from 30 to 75 kW with integrated thrust bearing.

Pump casing with axial suction and radial delivery on top, main dimensions and performance according to EN 733.

NM(S): version with pump casing and lantern bracket in cast iron.

B-NM(S): version with pump casing and lantern bracket/casing cover in bronze. (the pumps are supplied fully painted).

Connections: Flanges according to PN 10, EN 1092-2.

Counter-flanges (on request)

Sizes	Flanges
from NM 32/.. to NM 50/...	Screwed flanges EN 1092-1, PN 16
from NM 65/.. to NMS 100/250	Flanges for welding EN 1092-1, PN 10

Version with frequency converter (on request)

Applications

- For clean liquids without abrasives, which are non-aggressive for the pump materials (solids content up to 0,2%).
- For water supply.
- For heating, air conditioning, cooling and circulation plants.
- For civil and industrial applications.
- For fire fighting applications.
- For irrigation.

Operating conditions

Liquid temperature from -10 °C to +90 °C.

Ambient temperature up to 40 °C.

Total suction lift up to 7 m.

Maximum permissible working pressure up to 10 bar (16 bar for NM 65/12, NM 65/16 and NM 80/16).

Continuous duty.

Motor

2-pole induction motor, 60 Hz (n ≈ 3450 rpm).

NM, NMS: three-phase 220/380 V, 220/440 V, up to 3 kW;
380/660 V, from 4 to 75 kW;

Insulation class F.

Protection IP 54 (IP 55 for NMS).

Motor suitable for operation with frequency converter from 2,2 kW.

Classification scheme IE2 for three-phase motors from 0,75 kW to 5,5 kW, IE3 from 7,5 kW.

Constructed in accordance with: EN 60034-1; EN 60034-30.

Special features on request

- Other voltages. - Protection IP 55.
- Special mechanical seal.
- Packed gland (only for NM standard construction).
- Single-phase motor (NMM) up to 1.5 kW.
- Explosion proof construction in accordance with Directive 94/9 EEC (ATEX).
- Higher or lower liquid or ambient temperatures.
- Motor suitable for operation with frequency converter up to 1,5 kW.

Materials

Components	NM, NMS	B-NM, B-NMS
Pump casing Lantern bracket NM Casing cover for NMS	Cast iron GJL 200 EN 1561	Bronze G-Cu Sn 10 EN 1982
Lantern bracket NMS	Cast iron GJL 200 EN 1561	
Impeller	Cast iron GJL 200 EN 1561	Bronze G-Cu Sn 10 EN 1982
	Brass P- Cu Zn 40 Pb 2 UNI 5705 for NM, B-NM 32/12-16-20, NM, B-NM 40/20	
Shaft	AISI 303 up to 2.2 kW	Cr Ni Mo steel
	AISI 430 from 3 kW to 75 kW	AISI 316
Mechanical seal	Carbon - Ceramic - NBR	
Counter-flanges	Steel Fe 430B UNI 7070	

結構

直結離心式泵浦：22kW以下電動馬達軸心直接連接泵浦，標準馬達搭配新托架(短桿結構)，使用一體成形之止推軸承可支援30到75kW。

入口端對齊泵浦軸心，出口端至於泵浦頂部。

主要尺寸與性能依據EN733

NM(S)：泵浦外殼及托架為鑄鐵

B-NM(S)：泵浦外殼及托架為青銅(泵浦整體烤漆)

接口：法蘭口依據PN10, EN 1092-2

相對法蘭：(依需求提供)

尺寸	法蘭
NM 32/.. to NM 50/...	牙口法蘭 EN 1092-1, PN 16
NM 65/.. to NMS 100/250	焊口法蘭 EN 1092-1, PN 10

搭配變頻器 (依需求提供)

應用

- 乾淨液體無雜質，不具腐蝕性(固體含量不超過0.2%)
- 供水系統
- 加熱、空調、冷卻及循環設備
- 民生及工業應用
- 消防系統應用
- 農業灌溉應用

操作條件

液體溫度-10°C至90°C

周圍溫度至40°C

總吸入揚高至7m

泵浦可承受之最大壓力值：10bar

(NM 65/12; NM 65/16; NM 80/16之泵浦為16bar)

連續運轉

馬達

2極感應馬達，60Hz(n=3450rpm)

NM, NMS： 三相220/380V, 220/440V, 至3kW
380/660V, 4至75kW

絕緣等級：F

保護等級：IP54(NMS使用IP55)

2.2kW以上之馬力可直接搭配變頻器使用。

三相馬達0.75kW至5.5kW使用歐盟效能指標高效率IE2, 7.5kW以上使用IE3

結構設計符合EN 60034-1; EN 60034-30之規範。

特殊需求

- 其他電壓
- 保護等級IP55
- 特殊機械軸封
- 格蘭墊片 (僅適用於NM標準結構)
- 單相馬達 (NMM) 至1.5kW
- 防爆馬達，依據94/9EEC (ATEX)
- 更高/低之液體或周遭溫度需求
- 1.5kW以上之馬力數，與變頻器搭配使用

材質

零件	NM, NMS	B-NM, B-NMS
泵浦外殼 托架 - NM 外罩 - NMS	鑄鐵 GJL 200 EN 1561	青銅 G-Cu Sn 10 EN 1982
托架 NMS	鑄鐵 GJL 200 EN 1561	
葉片	鑄鐵 GJL 200 EN 1561	青銅 G-Cu Sn 10 EN 1982
	NM, B-NM 32/12-16-20, NM, B-NM 40/20 之型號使用黃銅 P- Cu Zn 40 Pb 2 UNI 5705	
軸心	2.2 kW以下使用不鏽鋼 AISI 303	不鏽鋼
	不鏽鋼 AISI 430 3 kW 至 75 kW	AISI 316
機械軸封	碳精 - 陶瓷 - NBR	
相對法蘭	鐵 Fe 430B UNI 7070	

Pumps with frequency converter

The **NM EI** pumps are available with power from 0,55 kW up to 11 kW, the pumps are equipped with **I-MAT** installed on board which allows to realize a variable-speed system extremely compact and efficient, ideal in applications of water supply and in the distribution of hot and cold water.

The pump is equipped with transducers suitable for operation and is already programmed at the factory.

Advantages

- Energy saving
- Compact design
- Easy to use
- Programmable to suit the system requirements
- Reliability

Costruction

The system comprises of:

- Pump
- Induction motor
- I-MAT Frequency converter
- Motor adapter for the motor mounting of the frequency converter
- Connection cable between frequency converter and induction motor
- Transducers

Main features

- Rated motor power output from 0,55 kW to 11 kW
- Control range from 1750 to 3450 rpm (2-pole)
- Protection against dry running
- Protection against operations with closed valve ports
- Protection against system leakages
- Protection against overcurrent in the motor
- Protection against overvoltage and undervoltage of the power supply
- Protection against current unbalances between phases



泵浦搭配變頻器

NM EI 泵浦規格從0.55kW到11kW，在泵浦上配置**I-MAT**變頻器使系統更有效率，應用於供水設備及冷熱水設備。泵浦已裝有感應器，適用於各項操作，且完成程式設定。

優點

- 節能
- 簡潔設計
- 操作簡單
- 可依系統需求編輯程式
- 可靠

結構

該系統包括：

- 泵浦
- 電動馬達
- I-MAT變頻器
- 馬達固定座(變頻器安裝於馬達使用)
- 連接電纜(於變頻器及馬達之間)
- 壓力傳送器

主要特色

- 馬達額定輸出功率：0.55kW至11kW
- 控制範圍：1750至3450rpm(2極)
- 防乾轉保護裝置
- 防止系統在閥門於關閉情況下操作
- 防止系統漏水
- 馬達過電流保護裝置
- 防止欠相保護

Operating modes



Constant pressure mode
with pressure transducer

In this mode, the system maintains the preset pressure when the flow required by the installation changes.



Proportional pressure mode
with pressure transducer

In this mode the system changes the working pressure according to the required flow rate.



Constant flow mode
with flow meter

In this mode the system maintains a constant flow rate value in a point of the installation according to the required pressure.



Fixed speed mode
with setting of the speed preferential rotation.

In this mode, by changing the working frequency, you may choose any operational curve included within the working range.



Constant temperature mode
with temperature transducer

In this mode the system keeps the temperature constant inside a system by changing the speed of the pump.

操作模式

恆壓模式
與壓力感應器

此模式依水量變化來維持壓力設定值。

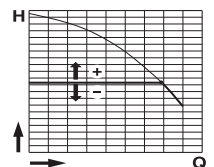

比例壓力模式
與壓力感應器

此模式依據流量來更變系統運轉壓力。

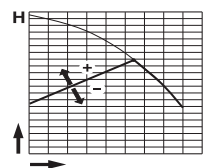

定量模式
與流量計

此模式依據需求壓力來維持流量值。

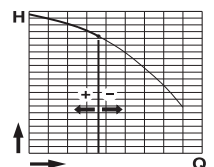

定速模式
與設定先取速度旋轉

此模式須選擇操作曲線包括運準範圍。

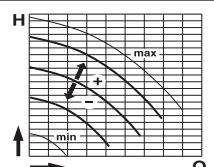

恆溫模式

與溫度感應器
依照泵浦速度變換，維持系統內部溫度。

Performance - 性能

n ≈ 3450rpm

B-NM	NM	P ₂		Q m ³ /h	6,6	7,5	8,4	9,6	10,8	12	13,2	15	16,8	18,9	21	24	27	30	
		kW	HP		l/min	110	125	140	160	180	200	220	250	280	315	350	400	450	500
				H m															
B-NM 32/12F-60	NM 32/12FE-60	0,55	0,75		17	16,8	16,5	15,9	15,3	14,5	13,6	12,1							
B-NM 32/12D-60	NM 32/12DE-60	0,75	1		18,8	18,5	18,3	17,8	17,2	16,5	15,8	14,4							
B-NM 32/12A-60	NM 32/12AE-60	1,1	1,5		24,3	24,1	23,8	23,4	22,8	22,2	21,4	20,1							
B-NM 32/12S-60	NM 32/12SE-60	1,5	2		25,2	25	24,8	24,3	23,8	23,2	22,5	21,2	19,7*	17,8*	15,6*	12*			
B-NM 32/16B-60	NM 32/16BE-60	1,5	2		31	30,5	30	29,5	29	28	27	25*	23*						
B-NM 32/16A-60/A	NM 32/16A-60/A	2,2	3		36,5	36	35,5	35	34	33	32,5	31*	29*						
B-NM 32/20D-60/A	NM 32/20D-60/A	2,2	3		39	38	37,5	36,9	35	34	32								
B-NM 32/20C-60/A	NM 32/20C-60/A	3	4		45	44,5	44	43	42	41	40	37	34*						
B-NM 32/20A-60/A	NM 32/20A-60/A	4	5,5		57	56,5	56	55,5	55	54	53	51	49*						

B-NM	NM	P ₂		Q m ³ /h	15	16,8	18,9	21	24	27	30	33	37,8	39	42	45	48	54	
		kW	HP		l/min	250	280	315	350	400	450	500	550	630	650	700	750	800	900
				H m															
B-NM 40/12F-60	NM 40/12F-60/A	1,1	1,5		15,4	14,9	14,3	13,4	11,8	10	7,8	5,6							
B-NM 40/12C-60	NM 40/12C-60/A	1,5	2		18,5	18,1	17,6	17	15,8	14,2	12,4	10,5	6,9						
B-NM 40/12A-60/A	NM 40/12A-60/B	2,2	3		22,5	22,3	21,9	21,4	20,6	19,6	18,3	16,7	13,7	12,9					
B-NM 40/16C-60/A	NM 40/16C-60/B	2,2	3		25,5	25,1	24,4	23,6	22,1	20,1	17,8	15,4	10,6						
B-NM 40/16B-60/A	NM 40/16B-60/B	3	4		31	30,6	30,3	29,6	28,5	27,1	25,4	23,2	19,2	18,1					
B-NM 40/16A-60/A	NM 40/16A-60/B	4	5,5		37,1	36,9	36,5	36,1	35,2	34,3	33,2	31,8	28,8	27,9	25,6	23			
B-NM 40/20C-60/A	NM 40/20C-60/A	4	5,5		44	43	42	41	39	36									
B-NM 40/20B-60/A	NM 40/20B-60/A	5,5	7,5		52	51,5	50,5	49,5	47,5	44,5	40	35							
	NM 40/20AR-60/A	5,5	7,5		56,5	56	55	54	52	49									
B-NM 40/200A-60/A	NM 40/20A-60/A	7,5	10	59,5	59	58,5	58	56	53,5	50,5	47	38,5							
B-NM 4025/C-60/C	NM 40/25C-60/C	9,2	12,5	65,4	65	64,4	63,5	61,5	58,6	54,2	49								
B-NM 4025/B-60/C	NM 40/25B-60/C	11	15	71,5	71,3	70,8	70,3	68,9	66,4	63,3	59,2	50							
B-NM 4025/A-60/C	NM 40/25A-60/C	15	20	90,4	90,2	89,7	89,1	88,5	87,3	86,1	83,8	78	76						

B-NM	NM	P ₂		Q m ³ /h	24	27	30	33	37,8	42	48	54	60	66	69	72	75	84	
		kW	HP		l/min	400	450	500	550	630	700	800	900	1000	1100	1150	1200	1250	1400
				H m															
B-NM 50/12F-60/A	NM 50/12F-60/B	2,2	3					16,1	15,4	14,2	13	11,1	8,6	5,8					
B-NM 50/12D-60/A	NM 50/12D-60/B	3	4					19,4	19	18	17	15,5	13,5	11,1	8,4				
B-NM 50/12A-60/A	NM 50/12A-60/B	4	5,5					24,8	24,6	24	23,4	22,3	20,8	19	17	16	14,8	13,6	
B-NM 50/160B-60/B	NM 50/16B-60/B	5,5	7,5					35,3	34,9	33,6	32,4	30,1	27,5	24,5	20,9	19	17,1	15,1	
B-NM 50/160A-60/B	NM 50/16A-60/B	7,5	10					42,7	41,6	41,2	40,3	38,5	36,3	33,8	30,9	29,4	27,8	26,1	20,4
B-NM 50/200B-60/C	NM 50/20B-60/C	9,2	12,5		51	50,6	50,4	49,8	48,5	47,1	44	40,5	36	30,2	27,3				
B-NM 50/200A-60/C	NM 50/20A-60/C	11	15		57,6	57,7	57,3	56,9	55,7	54,6	52,2	49,5	46	41,8	39	36,2	33,2		
B-NM 5025/C-60/C	NM 50/25C-60/C	11	15		61,9	61,2	60,3	59,3	57,2	55	50	44	36,5						
B-NM 5025/B-60/C	NM 50/25B-60/C	15	20		74,6	73,9	73,2	72	70,1	68,1	64,3	59,3	52,8	43,8					
B-NM 5025/A-60/C	NM 50/25A-60/C	18,5	25	87,6	87,3	86,9	86,2	84,7	83	79,8	76	72	66,9						

B-NM	NM	P ₂		Q m ³ /h	37,8	42	48	54	60	66	75	84	96	108	120	132	150	168	
		kW	HP		l/min	630	700	800	900	1000	1100	1250	1400	1600	1800	2000	2200	2500	2800
				H m															
	NM 65/12E-60/B	4	5,5		16	15,8	15,5	15,2	14,8	14,3	13,5	12,7	11,4	9,9					
B-NM 65/125C-60/B	NM 65/12C-60/B	5,5	7,5		21,4	21,2	21	20,6	20,3	19,8	19,1	18,3	17	15,3	13,1				
B-NM 65/125A-60/B	NM 65/12A-60/B	7,5	10		26,4	26,4	26,2	26,1	25,8	25,5	24,9	24,1	22,8	21,1	18,9				
B-NM 65/160D-60/B	NM 65/16D-60/B	7,5	10					24,4	24,2	23,9	23,6	23	22,3	21,2	19,7	17,6			
B-NM 65/160C-60/C	NM 65/16C-60/C	9,2	12,5					27,9	27,8	27,6	27,3	26,7	26	24,9	23,4	21,5	19		
B-NM 65/160B-60/C	NM 65/16B-60/C	11	15					32,8	32,7	32,5	32,2	31,7	31	29,9	28,5	26,8	24,4		
B-NM 65/160AR-60	NM 65/16AR-60	15	20					35,9	35,9	35,8	35,7	35,3	34,7	33,6	32,3	30,7	28,5		
B-NM 65/160A-60/C	NM 65/16A-60/C	15	20					40,7	40,7	40,6	40,5	40,1	39,6	38,6	37,3	35,5	33,2		
B-NM 65/200C-60/A	NM 65/20C-60/A	15	20					44	43,5	43	42,5	41	40	37,5*	35*	31*	27*		
B-NM 65/200B-60/A	NM 65/20B-60/A	18,5	25				49,5	49	48,5	48	47,5	46,5	44,5*	42*	38,5*	35*			
B-NM 65/20A-60	NM 65/20A-60	22	30				56	55,5	55	54,5	54	53,5	51*	48*	45*	41*			
B-NM 65/25C-60	NM 65/25C-60	22	30				64	63	62,5	61,5*	60*	57,5*	54,5*	50*					
B-NMS 65/250B-60	NMS 65/250B-60	30	40				79,5	79	78,5	78*	77*	75*	71*	66,5*					
B-NMS 65/250A-60/A	NMS 65/250A-60/A	37	50				90	89,5	89	88,5*	87*	86*	83*	78,5*					

Performance - 性能

n ≈ 3450 rpm

B-NM	NM	P ₂		Q m³/h l/min	H m															
		kW	HP		75	84	96	108	120	132	150	168	180	192	210	240	270	300		
B-NM 80/160E-60/B	NM 80/16E-60/B	7,5	10	H m	23,3	22,2	20,6	19	17,5	16	14,1	11,9								
B-NM 80/160D-60/C	NM 80/16D-60/C	9,2	12,5		26,9	25,9	24,6	23,1	21,6	19,9	17,5	15,1								
B-NM 80/160C-60/C	NM 80/16C-60/C	11	15		30,7	29,9	28,7	27,4	26	24,4	22	19,5	17,9							
B-NM 80/160B-60/C	NM 80/16B-60/C	15	20		35,5	34,9	34	32,9	31,6	30,2	27,8	25	23,1	21						
B-NM 80/160A-60/C	NM 80/16A-60/C	18,5	25		41,3	40,9	40,2	39,3	38,3	37,1	35	32,5	30,7	28,8						
B-NMS 80/200B-60/A	NM 80/20B-60	22	30		46,5	46	45,5	44,5	43,5*	42*	39*	35*	32*							
B-NMS 80/200A-60/A	NMS 80/200A-60	30	40		56	55,5	55	54	53,5*	52*	49*	46*	43*							
B-NMS 80/250E-60/A	NM 80/25E-60	22	30		51	50	48,5	46,5	44,5*	42*	38*	33*	29*							
B-NMS 80/250D-60/A	NMS 80/250D-60	30	40		65	64	62,5	61	59*	56,5*	53*	49*	45*	41*						
B-NMS 80/250C-60/A	NMS 80/250C-60/A	37	50		73,5	73	72	70,5	69*	67*	63*	59*	55*	51*						
B-NMS 80/250B-60/A	NMS 80/250B-60/A	45	60		84	83,5	82,5	81	80*	78*	74*	70*	67*	62,5*						
B-NMS 80/250A-60/A	NMS 80/250A-60/A	55	75		94,5	94	93	92,5	91,5*	90*	87,5*	84*	80*	76,5*						
B-NMS 100/200E-60/A	NM 100/200E-60/B	18,5	25					30	29,5	29	28	27	26*	24,5*	22,5*	19*				
B-NMS 100/200D-60/A	NM 100/20D-60	22	30					36	35,5	35	34	33	32*	31*	29*	24*				
B-NMS 100/200C-60/A	NMS 100/200C-60	30	40					45	44,5	44	43	42,5	41*	40*	39*	34*	28*			
B-NMS 100/200B-60/A	NMS 100/200B-60/A	37	50					54	53,5	53	52,5	51,5	50*	49*	47,5*	43*	38*			
B-NMS 100/200A-60/A	NMS 100/200A-60/A	45	60					61,5	61	60,5	60	59,5	59*	58*	56*	52,5*	48*	42°		
B-NMS 100/250B-60/A	NMS 100/250B-60/A	55	75					73,5	73	72,5	71,5	70	69*	67*	65*	60*	55*	48°		
B-NMS 100/250A-60/A	NMS 100/250A-60/A	75	100				90,5	90	90	89	88,5	87,5*	87*	85*	81*	75*	67°			

NM(S) Standard construction.
標準結構

B-NM(S) Bronze construction.
青銅結構

P₂ Rated motor power output.
馬達額定輸出功率

H Total head in m.
總揚程 (單位m)

* Maximum suction lift 1-2 m.
最大吸入揚高1-2m

◦ With 1 m suction head.
吸入揚程1m

Tolerances according to UNI EN ISO 9906:2012.
誤差值依據 ISO 9906:2012 之標準

Rated currents - 額定電流

P ₂		P ₂ *	SF	220V Δ / 380V Y			220V Δ / 440V Y		440V Δ	I _A /I _N
kW	HP	kW		380V Δ / 660V Y			In A	In A	In A	
0,55	0,75	0,63	1,15	4,5	2,6		4,7	2,7		5,2
0,75	1	0,86	1,15	4,8	2,8		5,0	3,0		4,8
1,1	1,5	1,27	1,15	5,7	3,3		6,0	3,5		5,5
1,5	2	1,75	1,15	9	5,2		9,4	5,5		5,4
2,2	3	2,55	1,15	11,1	6,5		11,7	6,8		7,3
3	4	3,45	1,15	13,4	7,7		14,0	8,1		8,4
4	5,5	4,55	1,15		11,2	6,5				7,8
5	7,5	6,3	1,15		13,7	7,9				8,7
7,5	10	8,6	1,15		17	9,8				9,2
9,2	12,5	10,6	1,15		22	12,7				8,2
11	15	12,6	1,15		25,8	14,9				8,5
15	20	17,3	1,15		33,2	19,2				9,4
18,5	25	21,3	1,15		41,2	23,8				9,3
22	30	24,5	1,15		48,9	28,3				9,2
30	40	33,5	1,15		65,4	37,8		55		8,7
37	50	41,5	1,15		82	47		66		8,5
45	60	51	1,15		97	56		81		8
55	75	62	1,15		119	68,5		97		7,2
75	100	84	1,15		157	90		132		6

P₂ Rated motor power output.
馬達額定輸出功率

* Power with S.F.
功率搭配 S.F.

I_A/I_N D.O.L. starting current / Rated current
啟動電流 / 額定電流

Rated power on the nameplate
額定功率顯示在名牌上

Characteristic curves - 性能曲線

$n \approx 3450 \text{ rpm}$

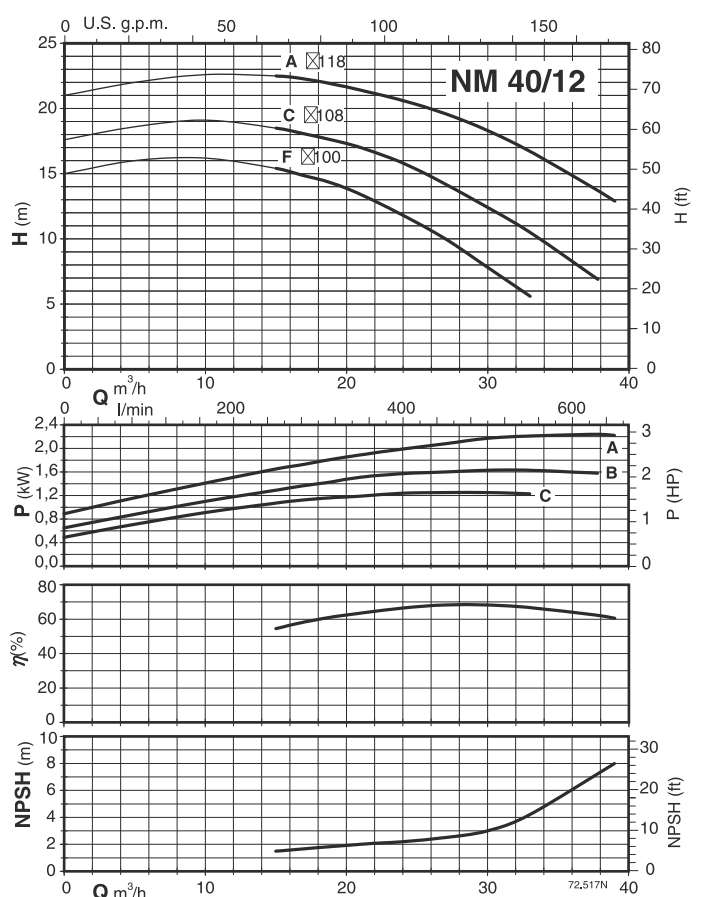
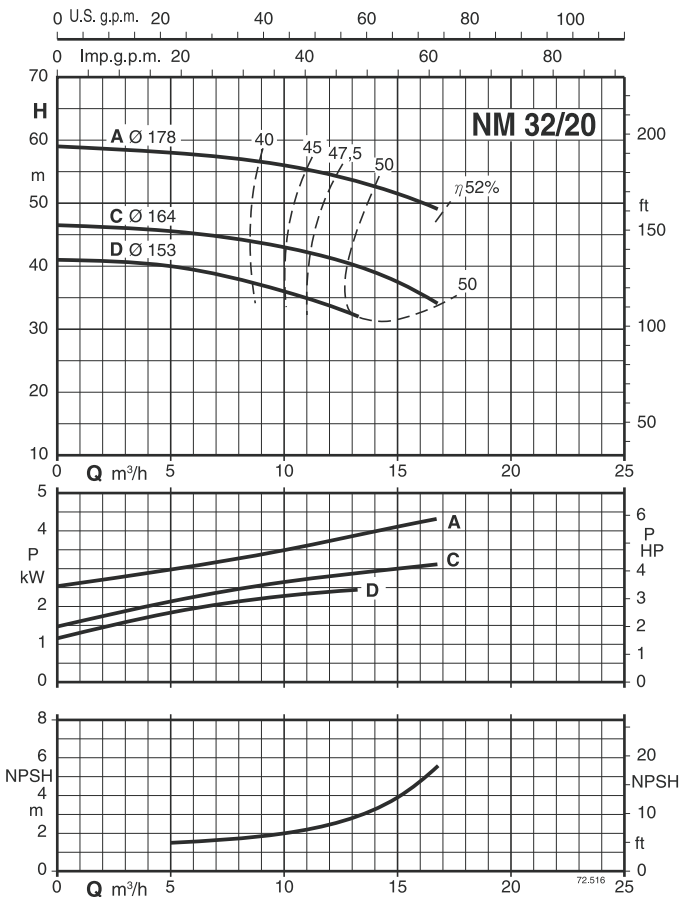
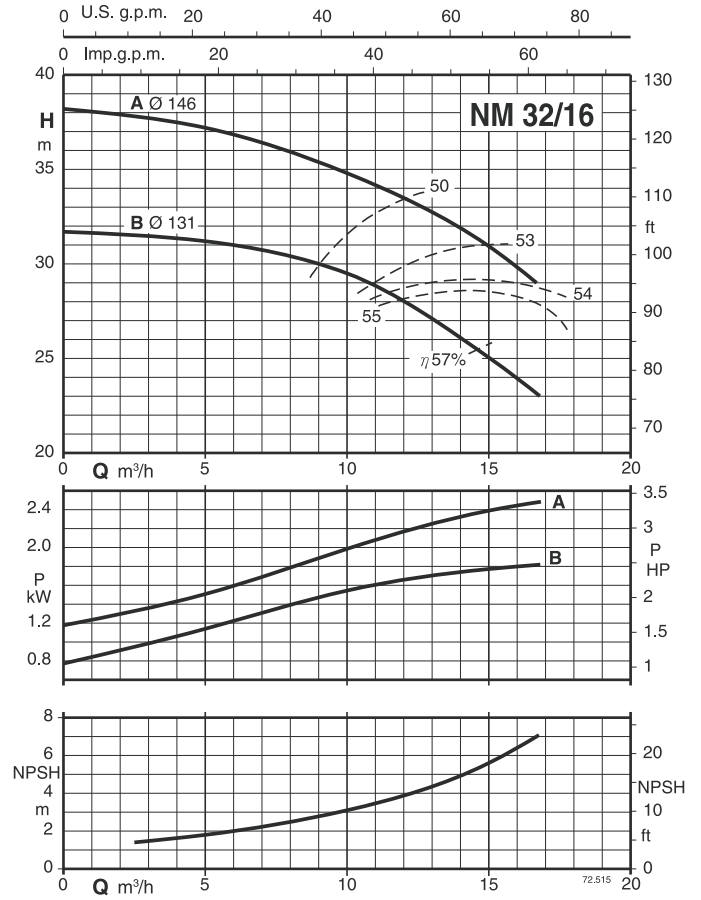
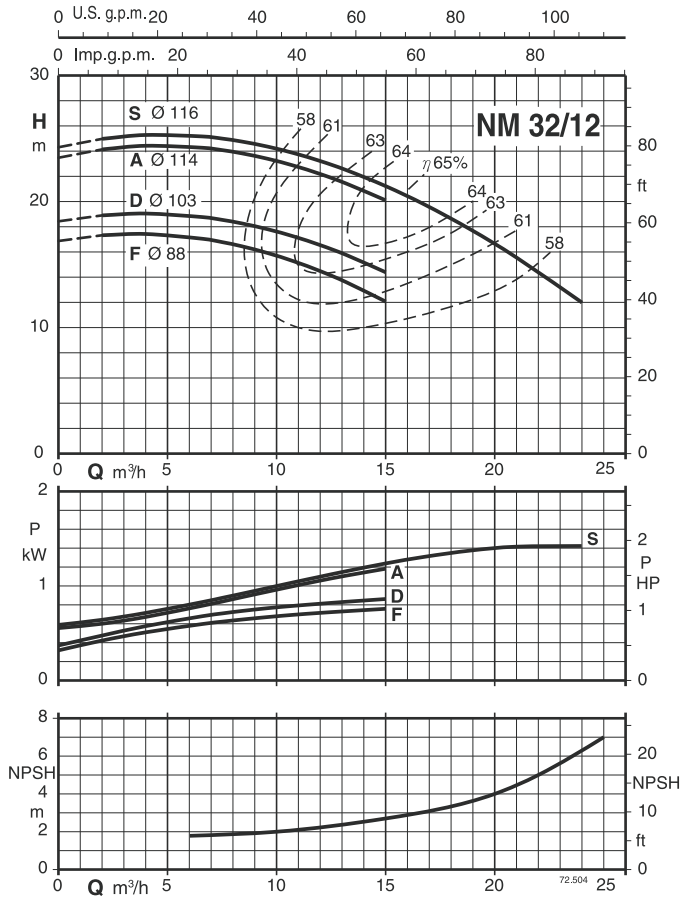

Characteristic curves - 性能曲線

$n \approx 3450$ rpm

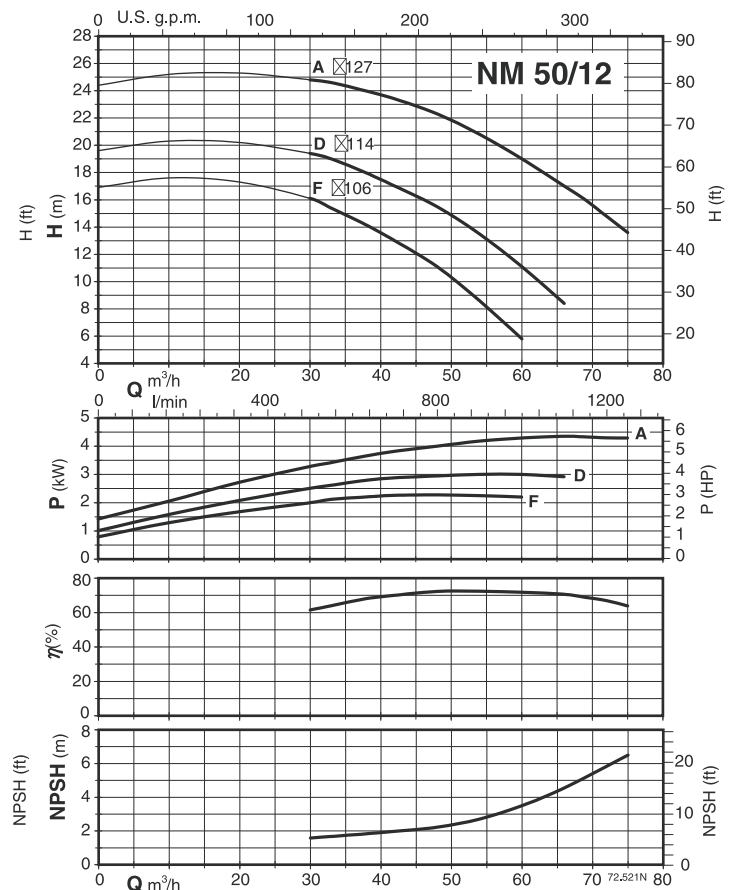
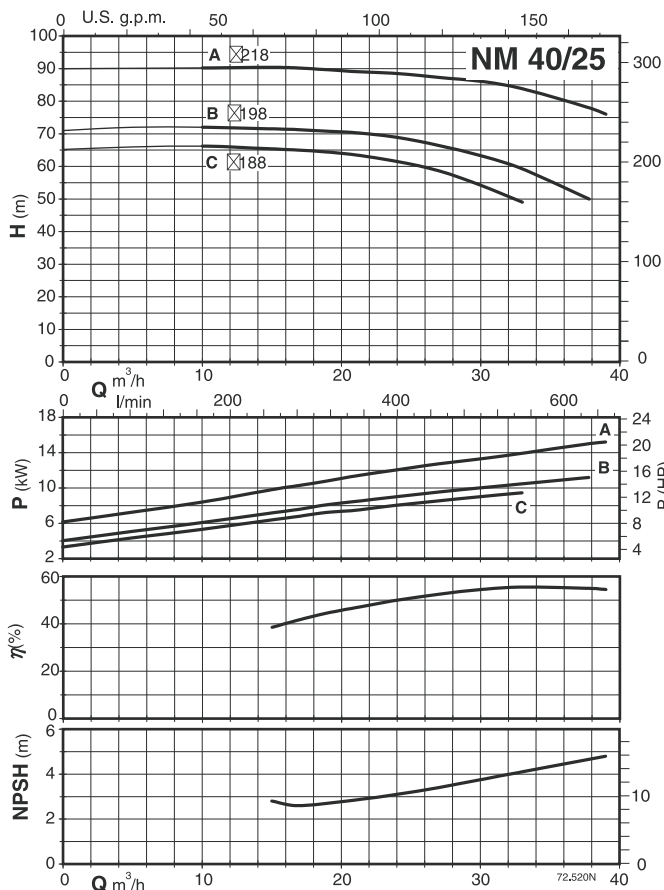
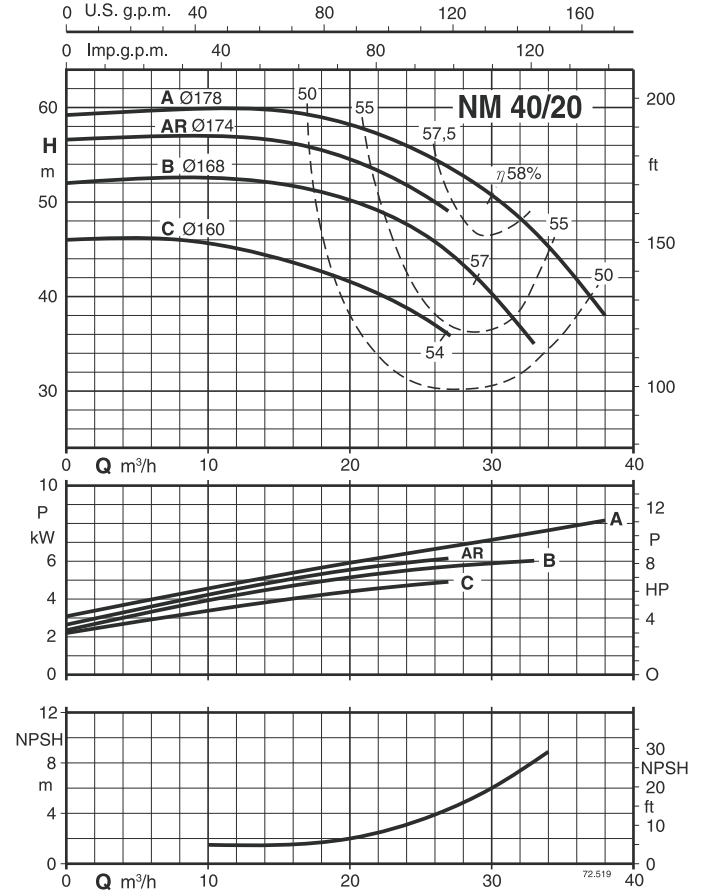
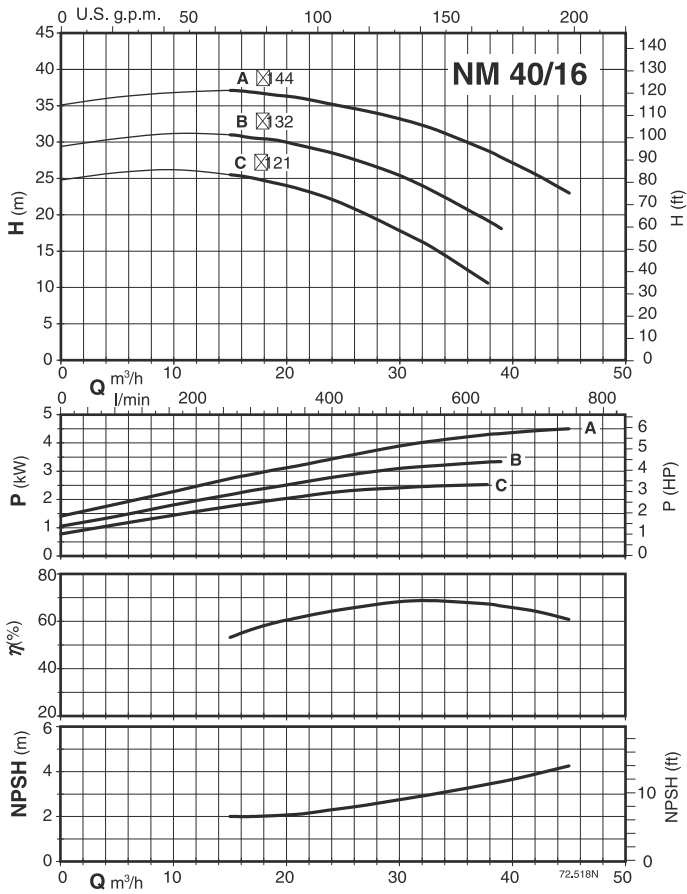

Characteristic curves - 性能曲線

$n \approx 3450$ rpm

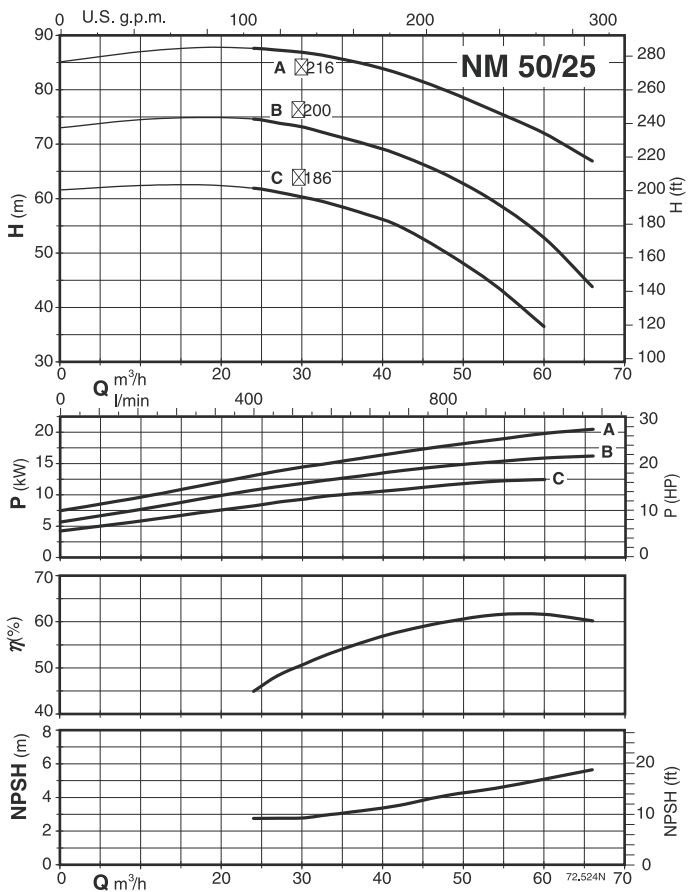
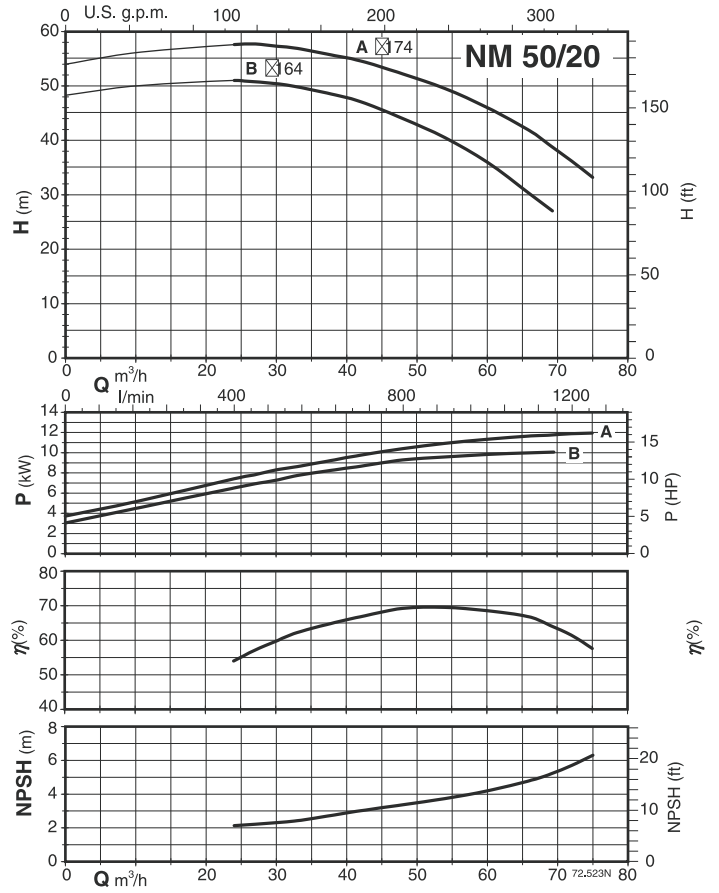
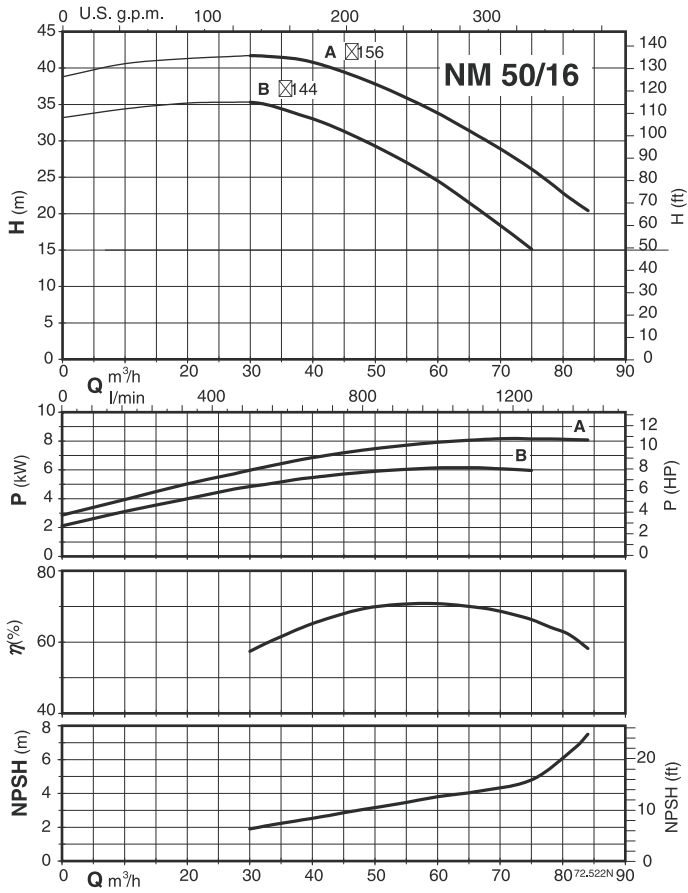

Characteristic curves - 性能曲線

$n \approx 3450$ rpm

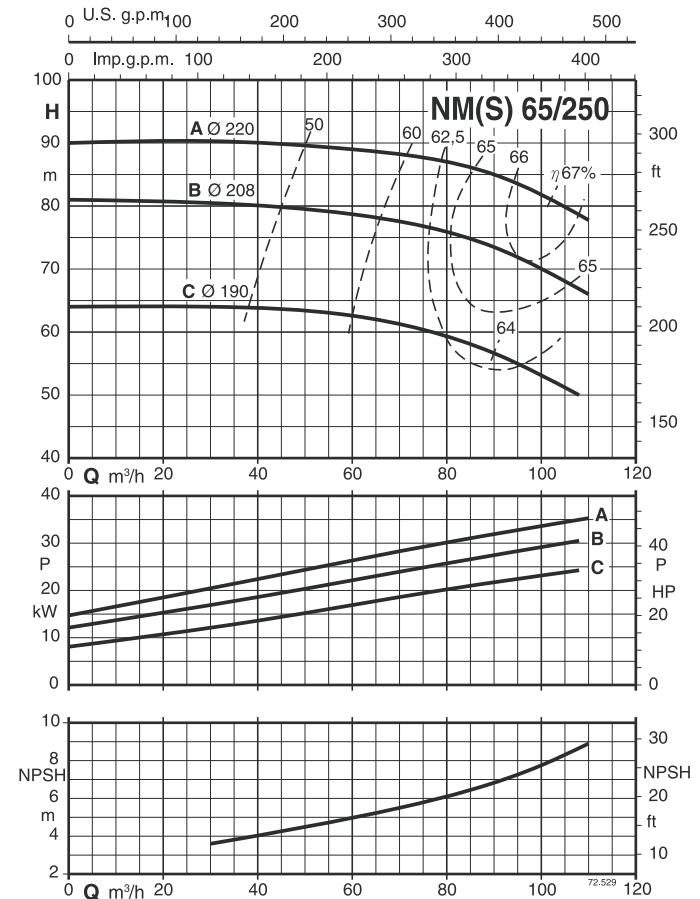
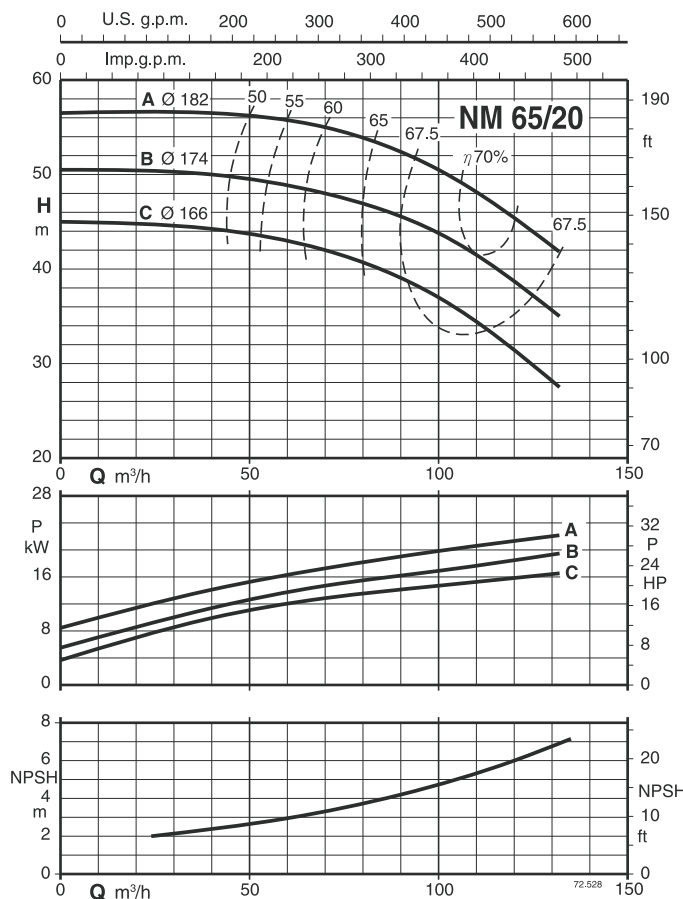
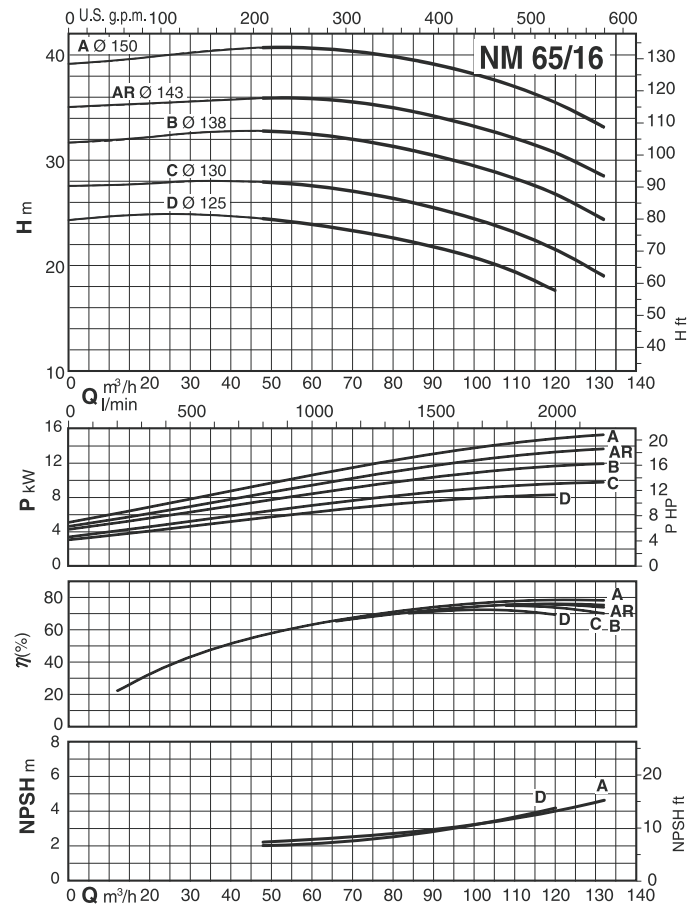
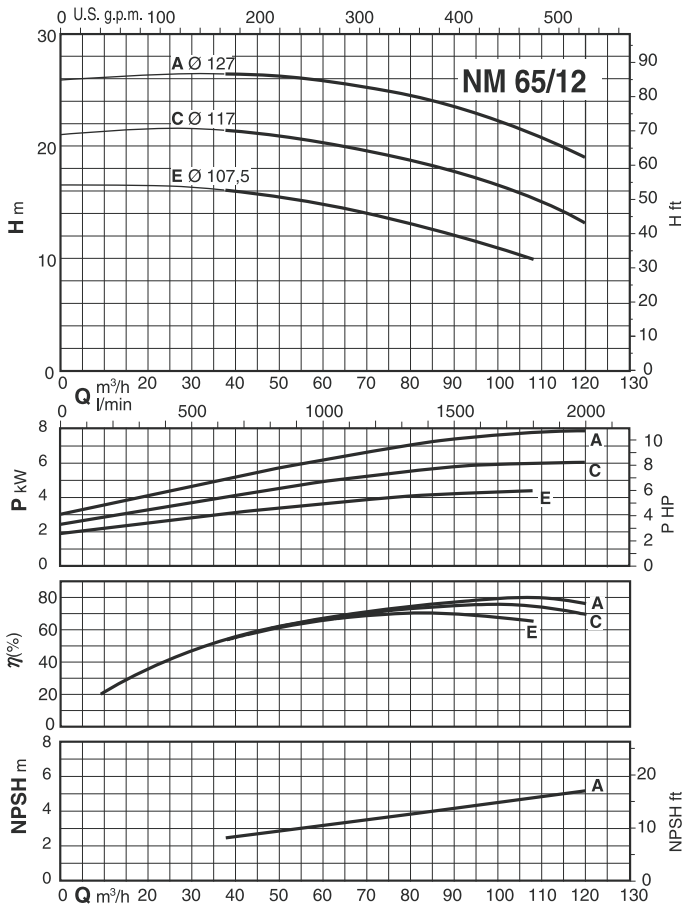

Characteristic curves - 性能曲線

$n \approx 3450$ rpm

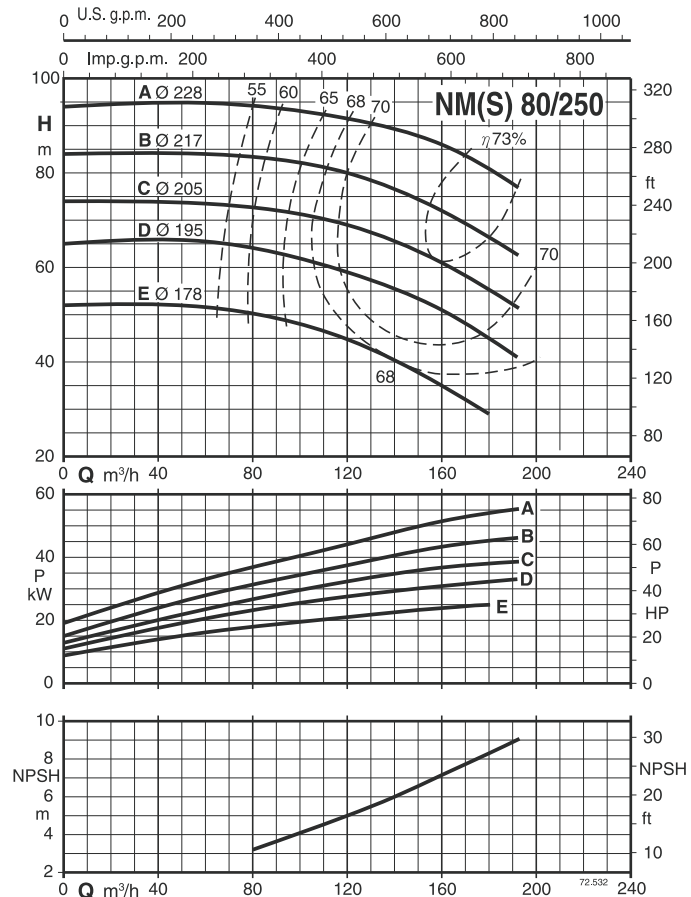
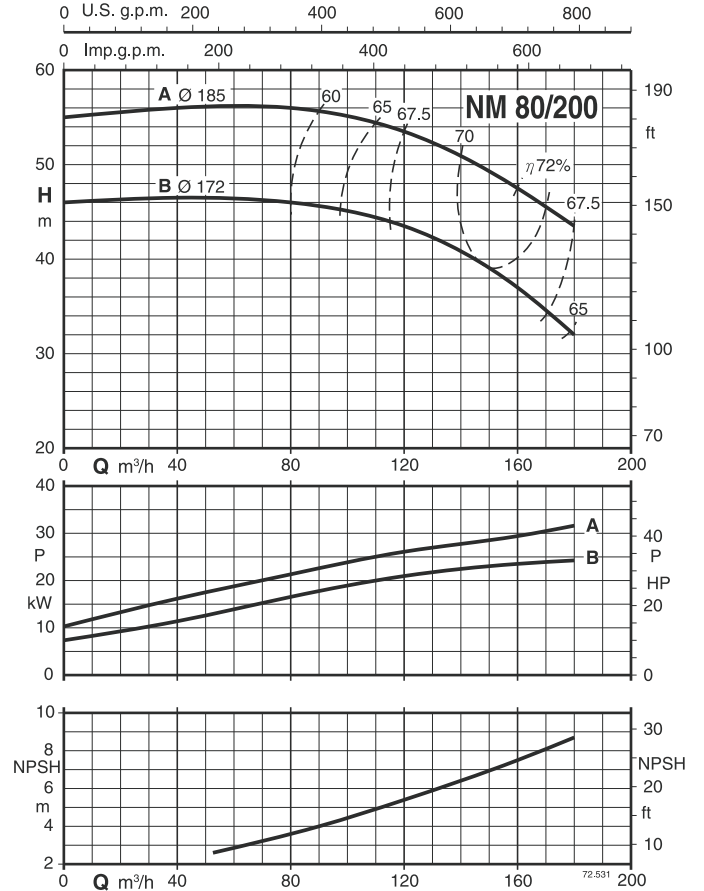
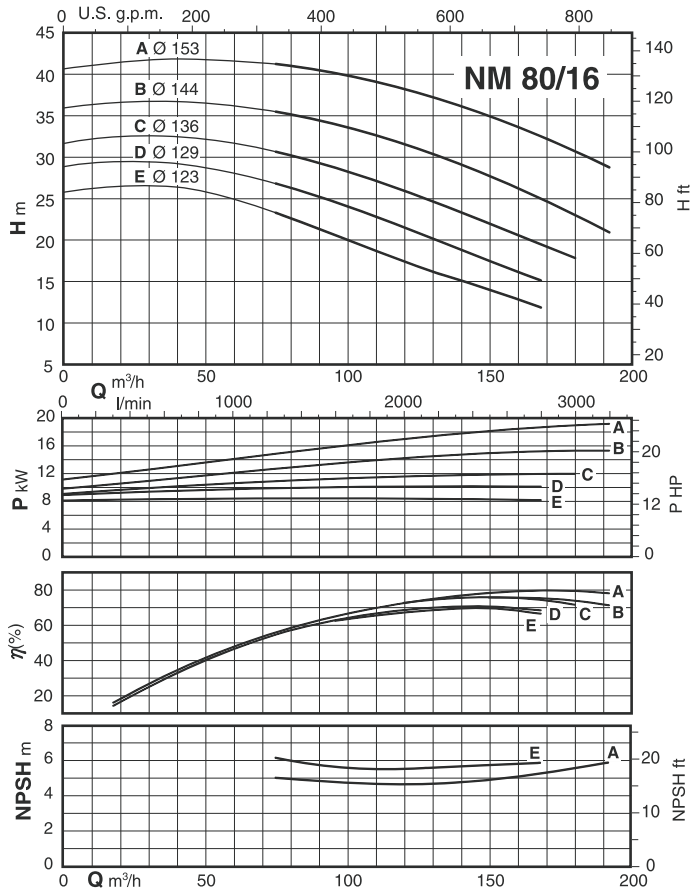

Characteristic curves - 性能曲線

$n \approx 3450$ rpm

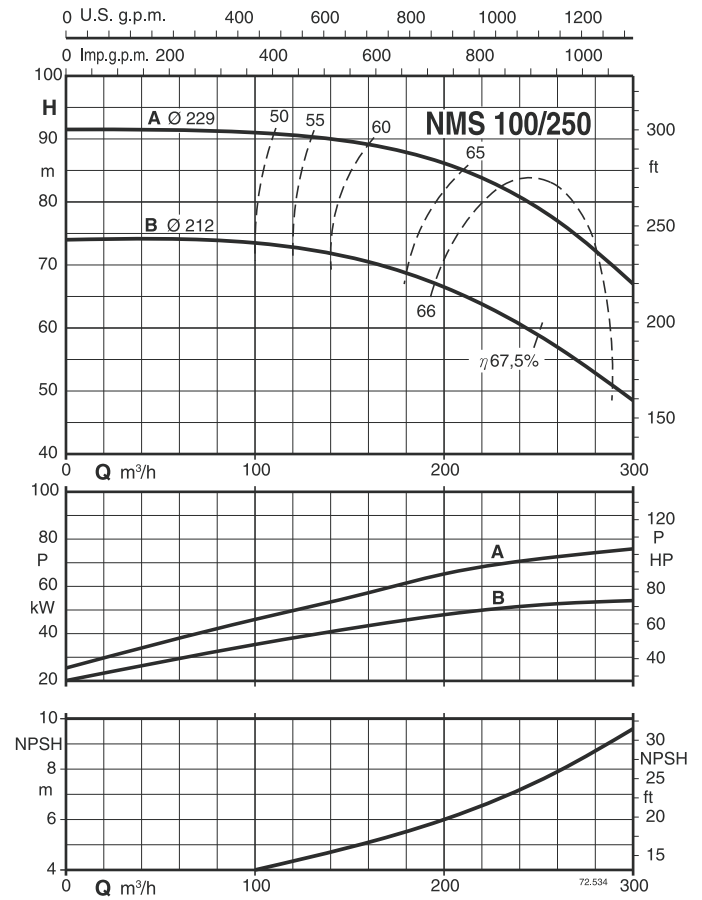
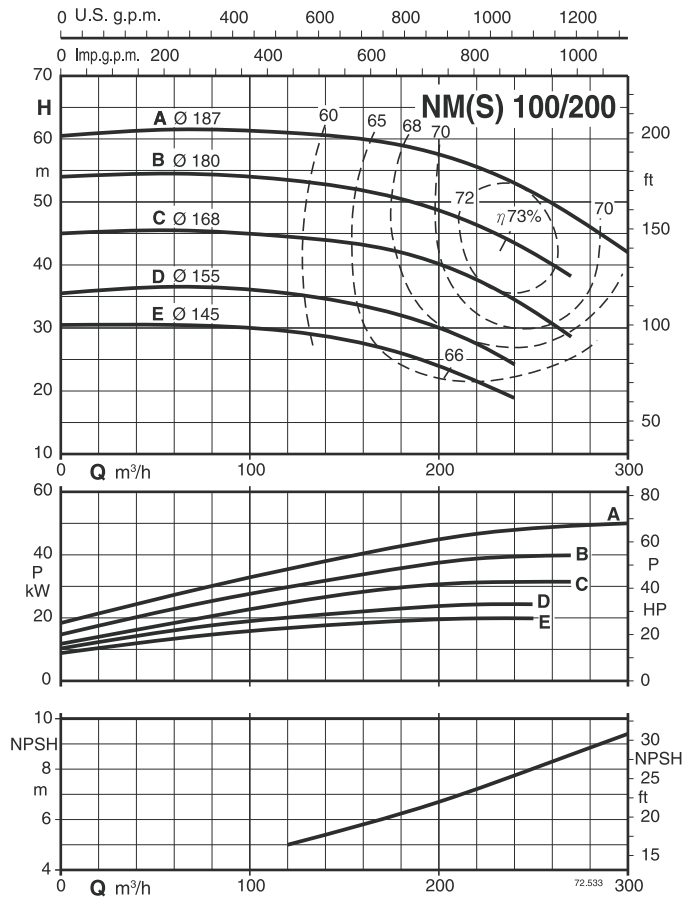

Dimensions and weights - 尺寸及重量

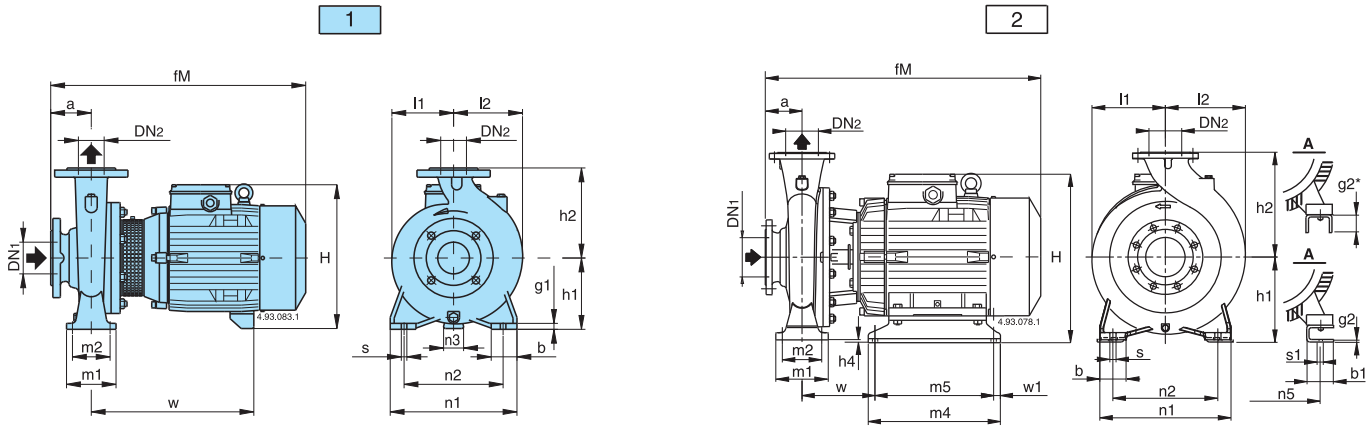

Picture 圖面	NM	mm																							kg				
		DN1	DN2	a	fM	h1	h2	H	h4	m1	m2	n1	n2	n3	n5	w1	b	b1	s	s1	l1	l2	w	m4		m5	g1	g2	
1	NM 32/12SE-60-AE-60 NM 32/12DE-60-FE-60	50	32	80	405	112	140	240	-	100	70	190	140	37	-	-	50	-	14	-	93	97	245	-	-	12	-	27-26-24-24	
	NM 32/16BE-60 NM 32/16A-60/A	50	32	80	410 450	132	160	260	-	100	70	240	190	47	-	-	50	-	14	-	120	120	250 290	-	-	12	-	34 39	
	NM 32/20D-60/A NM 32/20C-60/A NM 32/20A-60/A	50	32	80	450 475 475	160	180	288 298	-	100	70	240	190	62 60 60	-	-	50	-	14	-	140	140	290 295 295	-	-	12	-	42 47 51	
	NM 40/12C-60/A-F-60/A NM 40/12A-60/B	65	40	80	410 450	112	140	240	-	100	70	210	160	37	-	-	50	-	14	-	100	113	250 290	-	-	12	-	29-27 32	
	NM 40/16C-60/B NM 40/16B-60/B NM 40/16A-60/B	65	40	80	450 475 475	132	160	260 270 270	-	100	70	240	190	47 45 45	-	-	50	-	14	-	119	119	290 295 295	-	-	12	-	39 46 48	
	NM 40/20C-60/A-D-60/A NM 40/20A-60/A-AR-60/A-B-60/A	65	40	100	495 525	160	180	298 320	-	100	70	265	212	60 49	-	-	50	-	14	-	140	140	295 320	-	-	12	-	54-53 73-67-67	
	NM 40/25C-60/C NM 40/25B-60/C NM 40/25A-60/C	65	40	100	640 690 715	180	225	365	-	125	95	320	250	50	-	-	65	-	14	-	175	175	400 460 460	-	-	15	-	108 117 139	
	NM 50/12F-60/B NM 50/12D-60/B NM 50/12A-60/B-S-60/B	65	50	100	470 495 495	132	160	260 270 270	-	100	70	240	190	47 45 45	-	-	50	-	14	-	121	137	290 295 295	-	-	12	-	40 47 49-49	
	NM 50/16A-60/B-B-60/B	65	50	100	525	160	180	320	-	100	70	265	212	49	-	-	50	-	14	-	127	141	320	-	-	14	-	70,5-64	
	NM 50/20B-60/C NM 50/20A-60/C NM 50/20S-60/C	65	50	100	640 690 720	160	200	345	-	100	70	265	212	40	-	-	50	-	14	-	140	153	400 460 460	-	-	15	-	100 109 131	
	NM 50/25C-60/C NM 50/25B-60/C NM 50/25A-60/C	65	50	100	655 720 720	180	225	365	-	125	95	320	250	50	-	-	65	-	14	-	175	175	465 465 465	-	-	15	-	122 145 151	
	NM 65/12E-60/B NM 65/12A-60/B-C-60/B	80	65	100	500 530	160	180	298 320	-	125	95	280	212	60 49	-	-	65	-	14	-	134	156	300 325	-	-	15	-	51,9 70,7-64,7	
	NM 65/16D-60/B NM 65/16C-60/C NM 65/16B-60/C NM 65/16A-60/C-AR-60	80	65	100	525 640 690 715	160	200	320 345 345 345	-	125	95	280	212	49 40 40 40	-	-	65	-	14	-	150	172	320 410 410 460	-	-	15	-	70,5 93 112 127	
	NM 65/20C-60/B NM 65/20B-60/B	80	65	100	715	180	225	365	-	125	95	320	250	50	-	-	65	-	14	-	155	175	460	-	-	15	-	136 141	
	2	NM 65/20A-60	80	65	100	762	202	225	408	22	125	95	320	250	-	254	20	80	90	14	14	155	175	182	400	360	-	42*	185
		NM 65/25C-60	80	65	100	762	202	250	408	2	160	120	360	280	-	254	20	80	90	18	14	175	190	182	400	360	-	42*	201
	1	NM 80/16E-60/B NM 80/16D-60/C NM 80/16C-60/C NM 80/16B-60/C NM 80/16A-60/C	100	80	125	545 670 720 745 745	180	225	340 365 365 365 365	-	125	95	320	250	60 50 50 50 50	-	-	65	-	14	-	165	193	320 415 415 465 465	-	-	15	-	77,5 101 120 132 138
		NM 80/20B-60	100	80	125	787	202	250	408	22	160	120	345	280	-	254	20	80	90	18	14	170	194	182	400	360	-	42*	200-194
		NM 80/25E-60	100	80	125	787	202	280	408	2	160	120	400	315	-	254	20	80	90	18	14	191	210	182	400	360	-	42*	209-203
		NM 100/200E-60/B*	125	100	125	800	200	280	345	-	160	120	360	280	-	216	20	80	69	18	12	180	212	239	298	258	-	6	179
NM 100/20D-60		125	100	125	787	202	408	2	-	160	120	360	280	-	254	20	80	90	18	14	180	212	182	400	360	-	42*	201-195	

* Version without coupling guard
此版本無連軸防護網

Pumps with packed gland, dimensions available on request (excluded NMS).
若有格蘭墊片之需求，歡迎來電洽詢（NMS除外）。

Dimensions and weights - 尺寸及重量

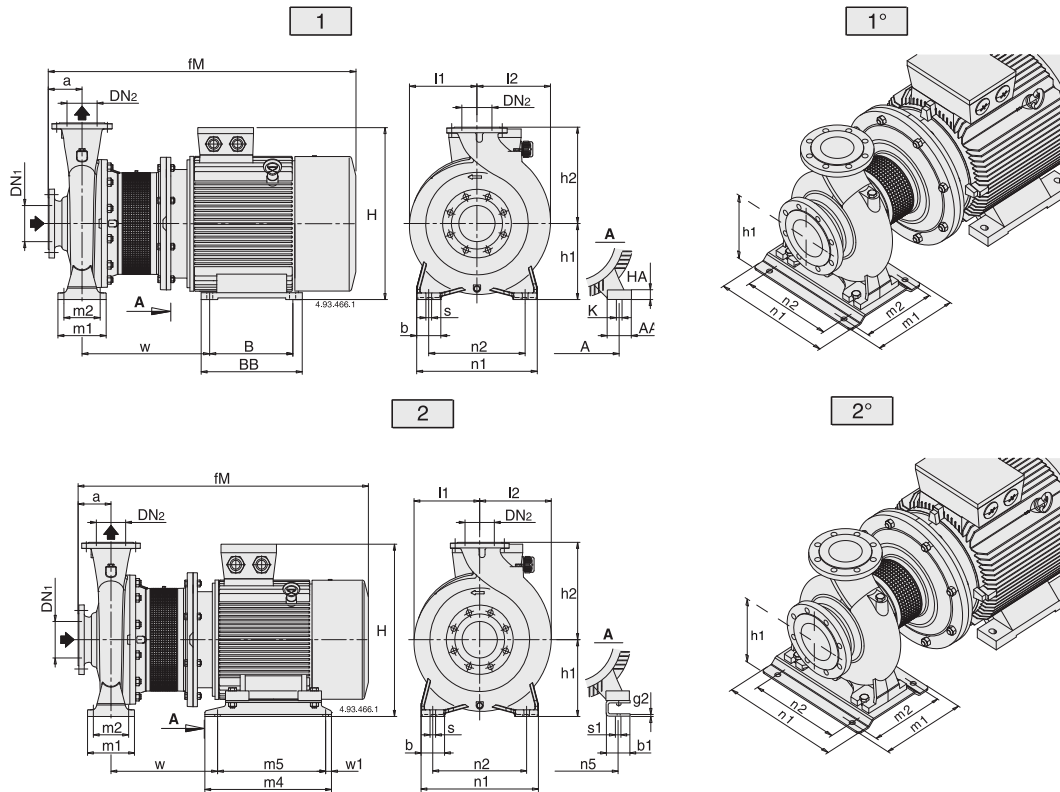

Picture 圖面	NMS	mm																												kg	
		DN1	DN2	a	fM	h1	h2	H	m1	m2	n1	n2	A	n5	w1	b	AA	b1	s	K	s1	l1	l2	w	BB	m4	B	m5	HA		g2
2	NMS 65/250B-60/A	80	65	100	961	200	250	486	160	120	360	280	-	279	20	80	-	70	18	-	15	177	189	333	-	440	-	400	-	20	-
1	NMS 65/250A-60/A	80	65	100	1074	200	250	500	160	120	360	280	318	-	-	80	70	-	18	19	-	200	200	406	355	-	305	-	25	-	321
1	NMS 80/200A-60/A	100	80	125	986	180	250	466	125	95	345	280	279	-	-	65	65	-	14	19	-	170	194	412	328	-	279	-	-	20	-
2	NMS 80/250D-60/A	100	80	125	986	200	280	486	160	120	400	315	-	279	20	80	-	70	18	-	15	191	211	333	-	440	-	400	-	20	-
1	NMS 80/250C-60/A	100	80	125	1099	200	280	500	160	120	400	315	318	-	-	80	70	-	18	19	-	200	210	406	355	-	305	-	25	-	333
1°	NMS 80/250B-60/A	100	80	125	1164	225	280	550	298	258	410	315	356	-	-	-	80	-	18	19	-	225	225	445	361	-	311	-	34	-	416
2°	NMS 80/250A-60/A	100	80	125	1235	280	280	672	260	220	410	315	-	406	25	-	-	100	18	-	24	275	275	443	-	500	-	450	-	8	-
2	NMS 100/200C-60/A	125	100	125	986	200	280	486	160	120	360	280	-	279	20	80	-	70	18	-	15	180	212	333	-	440	-	400	-	20	-
1	NMS 100/200B-60/A	125	100	125	1099	200	280	500	160	120	360	280	318	-	-	80	70	-	18	19	-	200	212	406	355	-	305	-	25	-	321
1°	NMS 100/200A-60/A	125	100	125	1164	225	280	550	298	258	410	315	356	-	-	-	80	-	18	19	-	225	225	445	361	-	311	-	34	-	409
2°	NMS 100/250B-60/A	125	100	140	1250	280	280	672	260	220	410	315	-	440	25	-	-	100	18	-	24	275	275	443	-	500	-	450	-	8	545
1°	NMS 100/250A-60/A	125	100	140	1324	280	280	712	260	220	410	315	457	-	-	-	100	-	18	24	-	275	275	516	479	-	368	-	40	-	639

Flanges - 法蘭 EN 1092-2

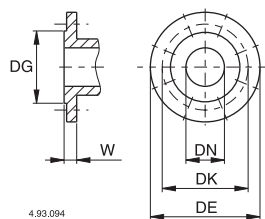

mm					
DN	DG	DK	DE	Holes 孔徑	
				N°	Ø
32	76	100	140	4	19
40	84	110	150	4	19
50	99	125	165	4	19
65	118	145	185	4	19
80	132	160	200	8	19
100	156	180	220	8	19
125	184	210	250	8	19

Dimensions and weights - 尺寸及重量

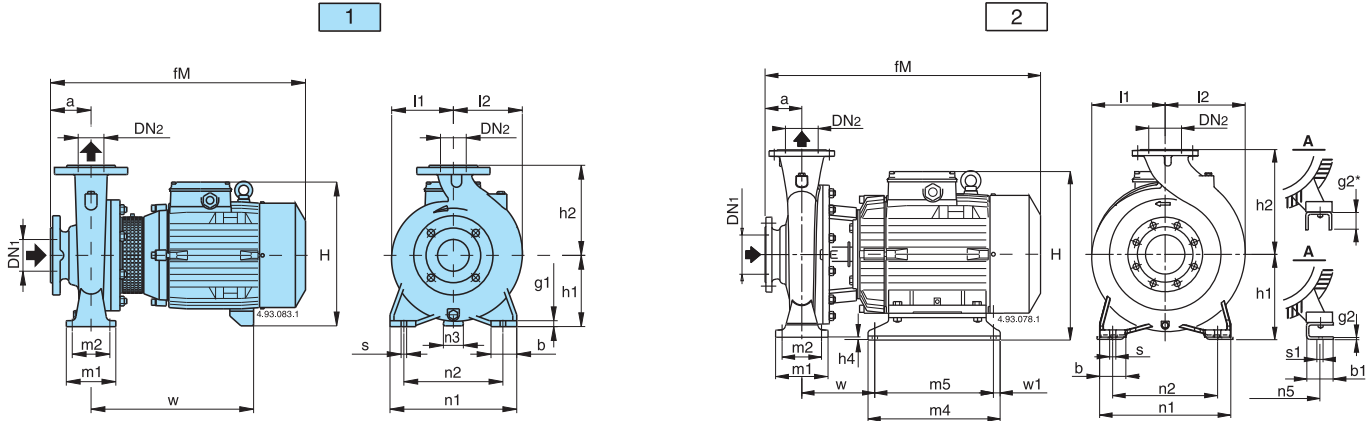

Picture 圖面	B- NM	mm																				kg						
		DN1	DN2	a	fM	h1	h2	H	h4	m1	m2	n1	n2	n3	n5	w	b	b1	s	s1	l1	l2	w	m4	m5	g1	g2	B- NM
1	B-NM 32/12D-60-F-60 B-NM 32/12S-60-A-60	50	32	80	405	112	140	240	-	100	70	190	140	37	-	-	50	-	14	-	93	97	245	-	-	12	-	30-28-27-27 30-28-27-27
	B-NM 32/16B-60 B-NM 32/16A-60/A	50	32	80	410 450	132	160	260	-	100	70	240	190	47	-	-	50	-	14	-	120	120	250 290	-	-	12	-	38,5 42
	B-NM 32/20D-60/A B-NM 32/20C-60/A B-NM 32/20A-60/A	50	32	80	450 475 475	160	180	288 298 298	-	100	70	240	190	45 60 60	-	-	50	-	14	-	140	140	290 295 295	-	-	12	-	47,5 56,5 58
	B-NM 40/12C-60-F-60 B-NM 40/12A-60/A	65	40	80	410 450	112	140	240	-	100	70	210	160	37	-	-	50	-	14	-	100	113	250 290	-	-	12	-	33-31 36
	B-NM 40/16C-60/A B-NM 40/16B-60/A B-NM 40/16A-60/A	65	40	80	450 475 475	132	160	260 270 270	-	100	70	240	190	47 45 45	-	-	50	-	14	-	119	119	290 295 295	-	-	12	-	43 50 53
	B-NM 40/20C-60/A-D-60/A B-NM 40/200A-60/A-B-60/A	65	40	100	495 580	160	180	298 320	-	100	70	265	212	60 49	-	-	50	-	14	-	140	140	295 375	-	-	12	-	59,5-59 80,5-75
	2	B-NM 4025/C-60/C B-NM 4025/B-60/C B-NM 4025/A-60/C	65	40	100	635 685 710	192	225	377	12	125	95	320	250	-	216	20	65	69	14	12	175	175	174	298	258	-	6
B-NM 50/12F-60/A B-NM 50/12D-60/A B-NM 50/12A-60/A-S-60/A		65	50	100	470 495 495	132	160	260 270 270	-	100	70	240	190	47 45 45	-	-	50	-	14	-	121	137	290 295 295	-	-	12	-	44 52 54,5-54
B-NM 50/160A-60/B-B-60/B		65	50	100	580	160	180	320	-	100	70	265	212	49	-	-	50	-	14	-	127	141	375	-	-	14	-	80-74,5
2	B-NM 50/200B-60/C B-NM 50/200A-60/C B-NM 50/200S-60/C	65	50	100	695 745 769	192	200	377	32	100	70	265	212	-	216	20	50	69	14	12	140	153	234	298	258	-	6	123 132 154
	B-NM 5025/C-60/C B-NM 5025/B-60/C B-NM 5025/A-60/C	65	50	100	685 710 710	192	225	377	12	125	95	320	250	-	216	20	65	69	14	12	175	175	174	298	258	-	6	135 156 161
	B-NM 65/125A-60/B-C-60/B B-NM 65/160D-60/B B-NM 65/160C-60/C	80	65	100	585 575 660	160	180	320 345	-	125	95	280	212	49 40	-	-	65	-	14	-	134	156	380 375 430	-	-	15	-	80,5-74,5 83,5-79 106
2	B-NM 65/160B-60/C B-NM 65/160A-60/C-AR-60	80	65	100	745 770	192	200	377	32	125	95	280	212	-	216	20	65	69	14	12	150	172	234	298	258	-	6	133 156
	B-NM 65/200B-60/B-C-60/B B-NM 65/200A-60/B	80	65	100	775 825	192 202	225 408	377 22	12	125	95	320	250	-	216 254	20	65 90	69 90	14 14	12 14	155	175	239 245	298 400	258 360	-	6 42*	183-169,5 200
	B-NM 65/250C-60/B	80	65	100	825	202	250	408	2	160	120	360	280	-	254	20	80	90	18	14	175	190	245	400	360	-	42*	210
1*	B-NM 80/160E-60/B B-NM 80/160D-60/C	100	80	125	605 685	180	225	340 365	-	125	95	320	250	60 50	-	-	65	-	14	-	165	193	375 430	-	-	15	-	94 114
	B-NM 80/160C-60/C B-NM 80/160B-60/C B-NM 80/160A-60/C	100	80	125	775 800 800	192	225	377	12	125	95	340	250	-	216	20	65	69	14	12	165	193	239	298	258	-	6	140 166 172

* Version without coupling guard
此版本無連軸防護網

Dimensions and weights - 尺寸及重量

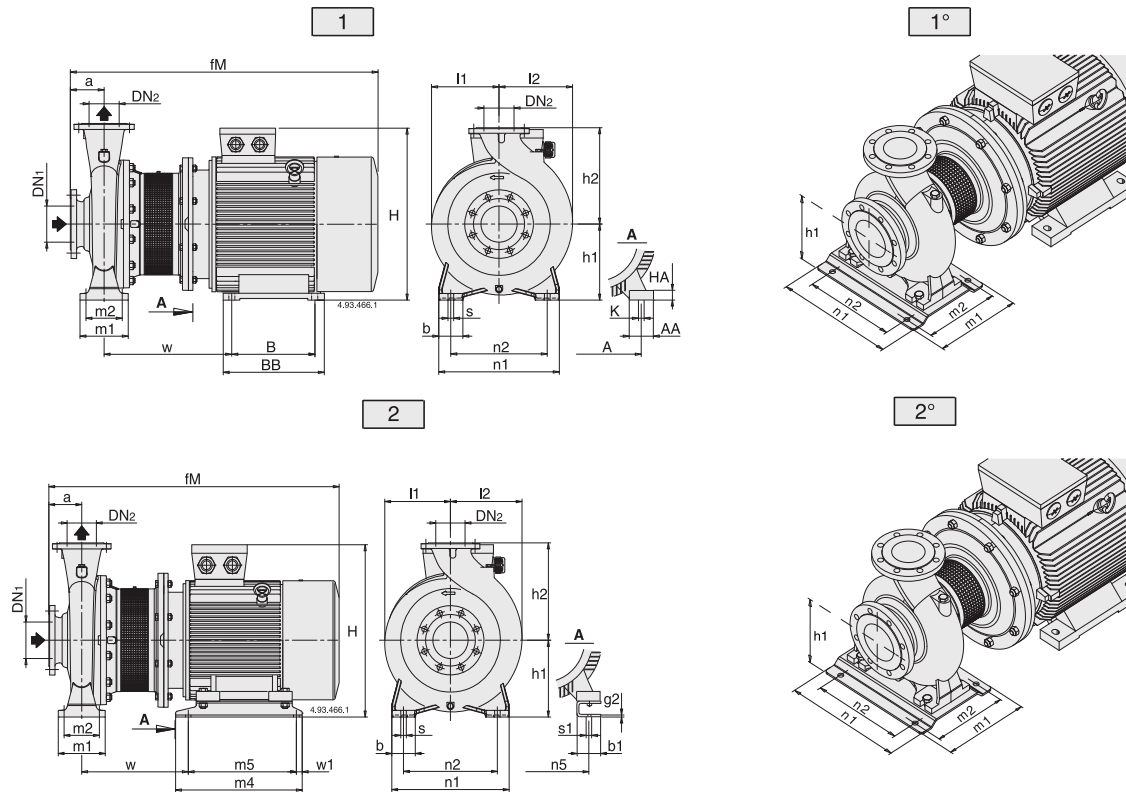

Picture 圖面	B-NMS	mm																										kg			
		DN1	DN2	a	fM	h1	h2	H	m1	m2	n1	n2	A	n5	w1	b	AA	b1	s	K	s1	l1	l2	w	BB	m4	B		m5	HA	g2
2	B-NMS 65/250B-60/A	80	65	100	961	200	250	486	160	120	360	280	-	279	20	80	-	70	18	-	15	177	189	333	-	440	-	400	-	20	
1	B-NMS 65/250A-60/A	80	65	100	1074	200	250	500	160	120	360	280	318	-	-	80	70	-	18	19	-	200	200	406	355	-	305	-	25	-	
2	B-NMS 80/200B-60/A	100	80	125	936	180	250	387	125	95	345	280	-	254	20	65	-	60	14	-	15	175	194	331	-	350	-	310	-	5	
1	B-NMS 80/200A-60/A	100	80	125	986	180	250	486	125	95	345	280	279	-	-	65	65	-	14	15	-	170	194	412	328	440	279	-	-	20	
2	B-NMS 80/250E-60/A	100	80	125	936	200	280	407	160	120	400	315	-	254	20	80	-	60	18	-	15	191	210	331	-	350	-	310	-	6	
2	B-NMS 80/250D-60/A	100	80	125	986	200	280	486	160	120	400	315	-	279	20	80	-	70	18	-	15	191	212	333	-	440	-	400	-	20	
1	B-NMS 80/250C-60/A	100	80	125	1099	200	280	500	160	120	400	315	318	-	-	80	70	-	18	19	-	200	210	406	355	-	305	-	25	-	
1°	B-NMS 80/250B-60/A	100	80	125	1164	225	280	550	298	258	410	315	356	-	-	-	-	18	19	-	225	225	445	361	-	311	-	34	-		
2°	B-NMS 80/250A-60/A	100	80	125	1235	280	280	672	260	220	410	315	-	406	25	-	-	100	18	-	24	275	275	443	-	500	-	450	-	8	
2	B-NMS 100/200E-60/A	125	100	125	882	200	280	386	160	120	360	280	-	216	20	80	-	69	18	-	12	180	212	322	-	298	-	258	-	6	418
2	B-NMS 100/200D-60/A	125	100	125	936	200	280	407	160	120	360	280	-	254	20	80	-	60	18	-	15	180	212	331	-	350	-	310	-	6	
2	B-NMS 100/200C-60/A	125	100	128	986	200	280	486	160	120	360	280	-	279	20	80	-	70	18	-	15	180	212	333	-	440	-	400	-	20	
1	B-NMS 100/200B-60/A	125	100	125	1099	200	280	500	160	120	360	280	318	-	-	80	70	-	18	19	-	200	212	406	355	-	305	-	25	-	
1°	B-NMS 100/200A-60/A	125	100	125	1164	225	280	550	298	258	410	315	356	-	-	-	-	18	19	-	225	225	445	361	-	311	-	34	-		
2°	B-NMS 100/250B-60/A	125	100	140	1250	280	280	672	260	220	410	315	-	440	25	-	-	100	18	-	24	275	275	443	-	500	-	450	-	8	
1°	B-NMS 100/250A-60/A	125	100	140	1324	280	280	712	260	220	410	315	457	-	-	-	-	100	-	18	24	-	275	275	516	479	-	368	-	40	-

Flanges - 法蘭 EN 1092-2

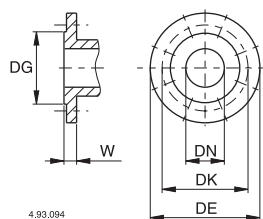

mm						
DN	DG	DK	DE	Holes 孔徑		W
				N°	Ø	
32	76	100	140	4	19	18
40	84	110	150	4	19	18
50	99	125	165	4	19	20
65	118	145	185	4	19	20
80	132	160	200	8	19	22
100	156	180	220	8	19	24
125	184	210	250	8	19	24

Features - 特色

Cutting edge hydraulics

The geometry of the impeller and the pump casing are optimized to achieve maximum efficiency and the best suction capability.

Flexibility

The option to choose between cast iron and bronze materials for the hydraulic parts in contact with the pumped liquid allows NM series pumps to be selected for use with different types of liquids.

Compact Design

The compact design allows for easy installation even in confined spaces.

Exclusive design

An innovative, patented guard prevents contact with rotating parts, providing protection to the end user whilst allowing for inspection of the mechanical seal.

Reliability

The bearing and shaft are designed to ensure the reduction of the stress, providing high reliability under all operating conditions.

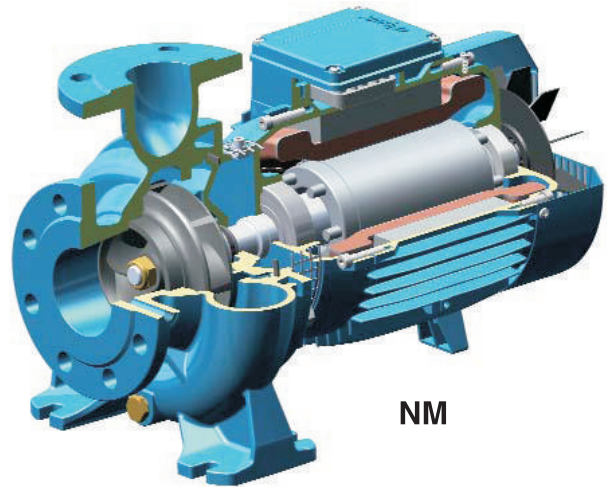

NM

水液壓零件進化

葉片及泵浦外殼的形狀進化可達到最高效率及最佳吸取功能。

靈活性

泵殼與葉片提供鑄鐵與銅質做搭配，使得NM系列的泵浦可在不同流體做多樣性應用。

簡潔設計

簡潔設計使在狹窄的空間也能輕鬆安裝。

獨家設計

創新、專利設計的防護網設計，可檢查軸封，同時也保護使用者避免意外。

可靠

軸承與軸心的設計為確保在操作情況下能在減少壓力同時提供高可靠性。

Cutting edge hydraulics

The geometry of the impeller and the pump casing are optimized to achieve maximum efficiency and the best suction capability.

Flexibility

The option to choose between cast iron and bronze materials for the hydraulic parts in contact with the pumped liquid allows NMS series pumps to be selected for use with different types of liquids.

New lantern bracket construction

The lantern brackets incorporate a thrust bearing on the hydraulic side which guarantees the elimination of additional loads on the motor bearings. The flange is sized to be used with standard motors B35.

Exclusive design

An innovative, patented guard prevents contact with rotating parts, providing protection to the end user whilst allowing for inspection of the mechanical seal.

Simplified motor maintenance

The presence of the thrust bearing on the hydraulic side makes it easier to remove the motor, facilitating maintenance operations and eliminating the risks of damage to the hydraulic parts.

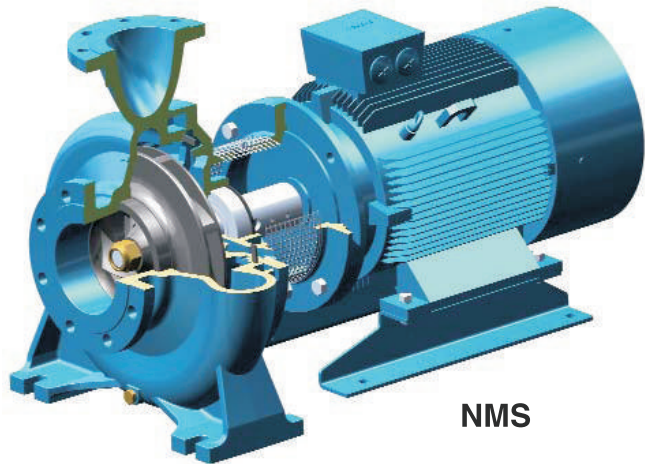

NMS

水液壓零件進化

葉片及泵浦外殼的形狀進化可達到最高效率及最佳吸取功能。

靈活性

泵殼與葉片提供鑄鐵與銅質做搭配，使得NM系列的泵浦可在不同流體做多樣性應用。

新托架結構

在水液壓零件上，托架與推力軸承合併時可消除馬達軸承上多餘的負荷，法蘭的尺寸與標準馬達B35使用。

獨家設計

創新、專利設計的防護網設計，可檢查軸封，同時也保護使用者避免意外。

簡易馬達保養

水液壓零件裡的推力軸承使摘除馬達、設備維修更加容易，及降低水液壓零件損壞風險。